



Thank you for selecting JELD-WEN products. Attached are JELD-WEN's recommended installation instructions for Wood Patio Doors with Exterior Trim or Nailing Fin. Read these instructions thoroughly before beginning. They are designed to work in most existing applications, however; existing conditions may require changes to these instructions. If changes are needed, they are made at the installer's risk. For installations other than indicated in these instructions, contact a building professional. Areas such as Florida and the Texas TDI region have different anchoring requirements based on product certification. For information on specific products, visit [www.floridabuilding.org](http://www.floridabuilding.org) or [www.tdi.texas.gov](http://www.tdi.texas.gov) and follow the anchoring schedule given in the drawings for the product instead of the anchoring schedule in this document.

### IMPORTANT INFORMATION, TABLE OF CONTENTS AND GLOSSARY

**Not all patio door types may be installed into every wall condition in all areas. Consult your local building code official for applicable building codes and regulations. Local building code requirements supersede recommended installation instructions.**

**PLEASE NOTE:** Any patio door installation where the sill is higher than 35 feet above ground level must be designed by an architect or structural engineer. Failure to install square, level and plumb and on a flat surface (without twist or warp) could result in denial of warranty claims for operational or performance problems.

**NOTE TO INSTALLER:** Provide a copy of these instructions to the building owner. By installing this product, you acknowledge the terms and conditions of the limited warranty as part of the terms of the sale.

#### Table of Contents

<a href="#">Landings</a> . . . . .	2
<a href="#">Rough Openings</a> . . . . .	2
<a href="#">Safety and Handling</a> . . . . .	3
<a href="#">Materials and Tools</a> . . . . .	3
<a href="#">Remove Packaging and Inspect Patio Door</a> . . . . .	4
<a href="#">Inspect Rough Opening</a> . . . . .	4
<a href="#">Prepare Patio Door</a> . . . . .	6
<a href="#">Install Patio Door</a> . . . . .	6
<a href="#">Complete Installation</a> . . . . .	8

#### Glossary

##### Applied Nailing Fin

A mechanically attached vinyl fin that creates a flange around the perimeter of the patio door and is used to position the patio door in the rough opening.

##### Backer Rod (backing material)

A material (e.g. foam rod), placed into a joint primarily to control the depth of the sealant.

##### Buck

A wood framework attached to the masonry inside a window or patio door rough opening.

##### Continuous Air Seal

Backer rod and sealant or low expansion foam applied to the interior gap between the product and the building in a continuous fashion used to block air flow between the interior and exterior of the building envelope.

##### Integral Nailing Fin

A fin that is part of the extruded aluminum cladding and used to attach the patio door to the rough opening.

##### Mulled Unit

Two or more door units structurally joined together.

##### Pilot Hole

A drilled hole that is no larger than the body of the screw (minus the threads).

##### Shiplap

The layering method in which each layer overlaps the layer below it so that water runs down the outside.

##### Sill Pan

A flashing component installed in the sill of the rough opening underneath the door. Sill pans have upturned walls along the interior edge and at both ends, creating a three-sided box. This component serves as a collection device to drain incidental water to the exterior of the building and should be properly sealed to the opening. The best sill pan design has a positive slope to the exterior and offers continuous support to the door's sill.

**LANDINGS**

**Landings**

These instructions cover two patio door sill conditions: the **step-down landing** and the **continuous slab landing**. The installation methods vary slightly between landing types.

**Step-Down Landing**

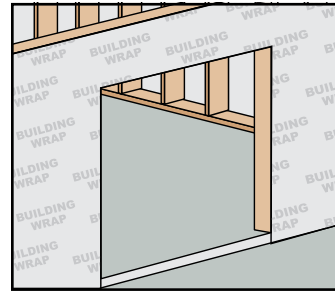

**Continuous Slab Landing**

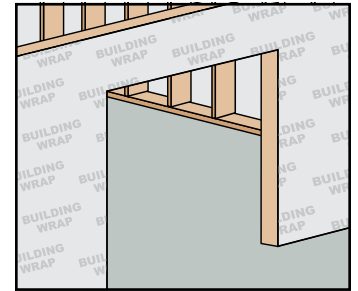

**ROUGH OPENINGS**

This installation guide only addresses masonry/block wall, sheathed wall and open-stud construction. If installing into an opening other than what is identified, consult a building professional.

**Masonry/Block Wall Construction**

This installation assumes that a framework of studs (often called a buck) has already been properly fastened in a weatherproof manner to the concrete/masonry wall.

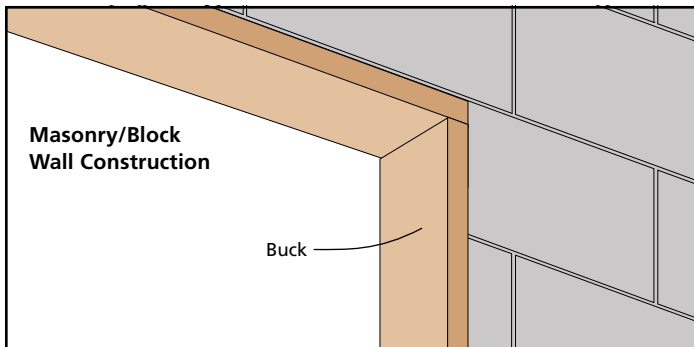

**Fully Sheathed Wall Construction**

Sheathing is applied to the exterior of the wall framing. The patio door will be mounted flush against the sheathing or building wrap in a weatherproof manner.

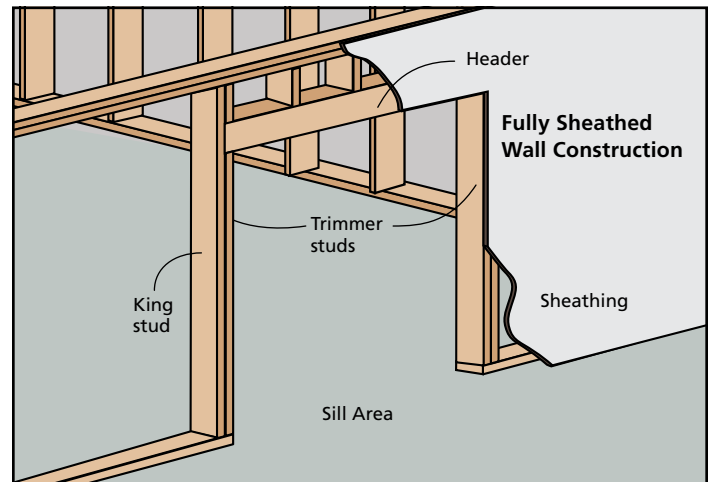

**Open-Stud Construction**

Sheathing is absent and building wrap is applied atop of the wall framing. The patio door will be mounted flush against building wrap and/or framing members (studs).

## SAFETY AND HANDLING

### Safety

- Read and fully understand ALL manufacturer's instructions before beginning. Failure to follow proper installation instructions may result in the denial of warranty claims for operational or performance problems.
- Do not work alone. Two or more people are required. Use safe lifting techniques.
- Use caution when handling glass. Broken or cracked glass can cause serious injury.
- Wear protective gear (e.g. safety glasses, gloves, ear protection, etc.).
- Operate hand/power tools safely and follow manufacturer's operating instructions.
- Use caution when working at elevated heights.
- If disturbing existing paint, take proper precautions if lead paint is suspected (commonly used before 1979). Your regional EPA ([www.epa.gov/lead](http://www.epa.gov/lead)) or Consumer Product Safety Commission offices provide information regarding regulations and lead protection.
- **WARNING!** Drilling, sawing, sanding or machining wood products generates wood dust, a substance known to the State of California to cause cancer. Use a respirator or other safeguards to avoid inhaling wood dust.

### Materials and Patio Door Handling

- Make sure the operating panel is secured prior to installation.
- Swinging Patio Doors: engage multi-point lock after installation.
- Heed material manufacturer's handling and application instructions.
- Protect adhesive surfaces from dirt, moisture, direct sunlight and folding over onto themselves.
- Handle in vertical position; do not drag on floor.
- Do not put stress on joints, corners or frames.
- Store patio door in dry, well-ventilated area in vertical, leaning position to allow air circulation; do not stack horizontally.
- Protect from exposure to direct sunlight during storage.
- Install only into vertical walls and when conditions and sheathing are dry.

**IF INJURY OCCURS, IMMEDIATELY SEEK MEDICAL ATTENTION!**

## MATERIALS AND TOOLS

### Provided Materials

- Doors with a fiberglass sill may include fasteners for use in the sill. Follow the instructions in the fastening section for applicable uses.
- 2 - #8 x 2" head bracket replacement screws (for Sliding Doors).
- Strike plate screws to secure to rough opening.

### Needed Materials

**NOTE: JELD-WEN exterior window and door products should be installed in accordance with JELD-WEN's recommended installation directions, which are shipped with the products or can be found on our website: [www.jeld-wen.com](http://www.jeld-wen.com). Note that alternative installation methods and flashing systems may be utilized at the installer's or owner's discretion and, in such situations the installation should be done in accordance with the flashing manufacturer's instructions. Follow all material manufacturer's instructions for proper use and compatibility. When using flashing, spray adhesive/primer, sealant and foam products, we recommend using the same manufacturer and verifying compatibility. It is the End User's responsibility to determine if dissimilar materials are compatible to the substrates in the application.**

- Wood: #8 x 1-1/4" pan head, corrosion-resistant screws. Fasteners must penetrate at least 1".
- Exterior trim products: 1-3/4" galvanized roofing nails or 1-3/4" galvanized casing nails. Fasteners must penetrate at least 1-1/2" into framing.
- Masonry/Concrete: 3/16" x 2" self-tapping concrete screws. Must penetrate at least 1-1/4".
- Non-compressible or non-water degradable shims.
- Sill pan: It is best practice to use a pre-formed, rigid, positively sloped, PVC pan that provides continuous support. We recommend using SureSill™ Sloped Sill Pan™, manufactured by SureSill™, Ltd. An alternative would be a non-sloped pre-formed sill pan or one that can be fabricated on site from metal or vinyl sheet material with the proper tools.

- Sealant: We recommend OSI® QUAD® Max Sealant or equivalent. This can be used in any application and can be painted or ordered in a color matched product, if desired.
- Backer rod 1/8" larger than the widest portion of the gap (used in conjunction with sealant bead).
- Polyurethane low expansion Window and Door foam: We recommend OSI® QUAD® Foam or equivalent).
- Drip cap material, if not supplied, required only for side-by-side mulled units that extends the length of the frame plus 1/8" overhang on each end. Apply according to local code.

### Needed Tools

- Hacksaw (SureSill™ sill pan) or Cutting shears (fabricated sill pan)
- Tape measure
- Utility knife
- Level (4' minimum recommended)
- J-roller
- Caulking gun
- Drill
- Screwdrivers
- Impact driver and 3/32" masonry bit

## 1 REMOVE PACKAGING AND INSPECT PATIO DOOR

### Remove Packaging

Remove shipping materials such as corner covers, shipping blocks or pads. Remove the skid board attached to the bottom of the door. Remove any staples exposed on the frame, but leave any glass protective films on.

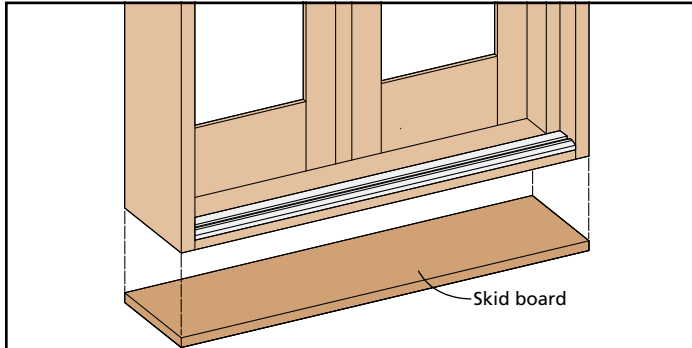

### Inspect Patio Door

- Cosmetic damage.
- Splits, cracks, holes, missing sections or other damage to the nailing fin longer than 6" and/or within 1/2" of patio door frame.
- Correct product (size, color, grid pattern, handing, glazing, energy-efficiency requirements, etc.).
- For side-by-side mulled units, a drip cap that extends the length of the frame plus 1/8" overhang on each end is required.

If any of the above conditions represent a concern, or if you expect environmental conditions to exceed the patio door's performance rating, do not install the patio door. Contact your dealer or distributor for recommendations.

## 2 INSPECT ROUGH OPENING

- Verify the width and height of the patio door are each 1/2"-3/4" smaller than the rough opening width/height. Mulled units should be 3/4" smaller.

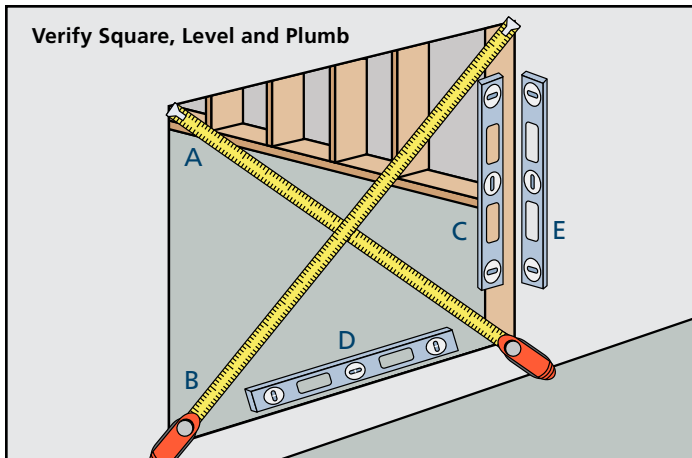

- Verify the rough opening is square. The (A) and (B) measurements should be the same. Maximum allowable deviation from square is 1/8" for doors less than 20 square feet and 1/4" for doors over 20 sq. feet.
- Verify the rough opening is plumb and level (C, E and D). The maximum allowable deviation is 1/8".
- The rough opening sill must not be crowned or sagged (D), but rather level or sloped (positive slope) to the exterior.
- The exterior face of the rough opening must be in a single plane (E) with less than 1/8" twist from corner to corner.
- Minimum double studs should be used at all wood framed rough openings.
- The header must be supported by trimmer studs.

### For Retrofit Installations

After removing the old patio door, remove sufficient cladding (siding, stucco, etc.) to expose enough intact building wrap to properly seal the patio door to the opening. If damaged, apply new building wrap in shiplap manner. Verify the rough opening framing is structurally sound. Contact your local waste management entities for proper disposal or recycling of products being removed.

**3**

**INSTALL SILL PAN**

**Install Sill Pan**

1. Install a sill pan in a weatherproof manner on the rough sill (refer to **ASTM 2112** for types of sill pans). Always allow water to drain out of the pan and onto the building wrap, drainage plane or to the exterior.
2. Set the sill pan in the rough opening, aligning the front edge (for continuous slab) or folded down edge (for step-down) with the exterior of the rough opening.
3. Mark a line across the front and back of the sill pan.
4. Apply three 3/8" beads of sealant between the lines.
5. Apply a 3/8" continuous bead of sealant across the sill pan back dam, in each corner and over the flashing joints as shown.

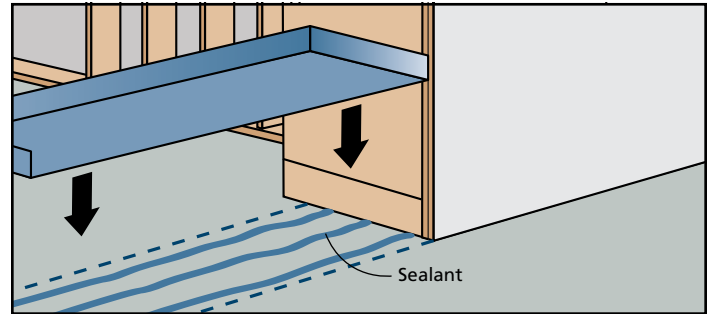
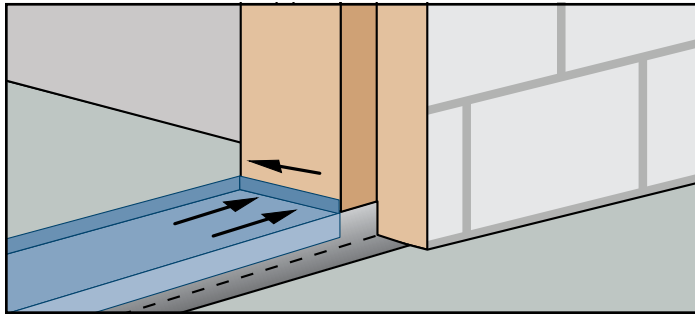

6. Place the sill pan in the rough opening. Firmly press the sill pan into the sealant with a J-roller.

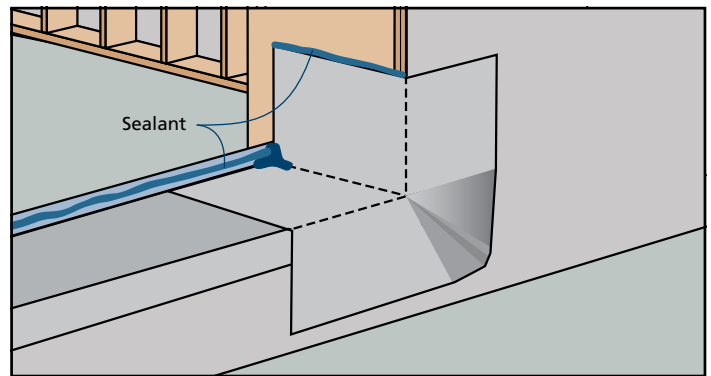

**4**

**PREPARE PATIO DOOR**

**Apply Drip Cap to Finned Doors**

1. With the exterior face up, apply a 1/4" bead of sealant across the header as shown (do not apply sealant to the groove).

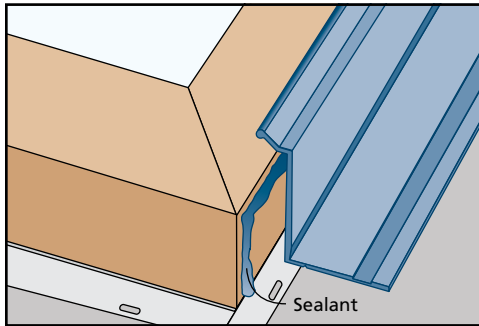

**Custom Doors only:**

Tap the drip cap into the groove with a wood block.

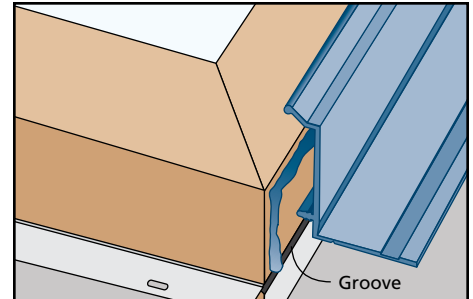

2. Inswing/outswing doors will need a strip of self-adhered flashing applied over the dead bolt or latch hole on the exterior side of the frame as shown.

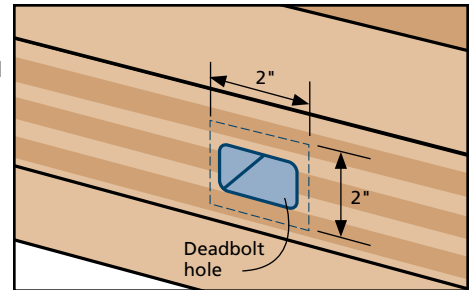

**5**

**INSTALL PATIO DOOR**

**WARNING! To avoid injury, use at least two people to install. Adequately support the door until fully installed.**

1. Run a continuous 3/8" bead of sealant around the interior side of the nail fin on the side jambs and head.
2. Tilt patio door into the rough opening. Make sure the back of the door makes solid contact with the sealant. Tool the sealant until smooth. Add more sealant if necessary to create a continuous seal.
3. Fasten patio door with the appropriate fastener between 3" and 4" from one upper corner.

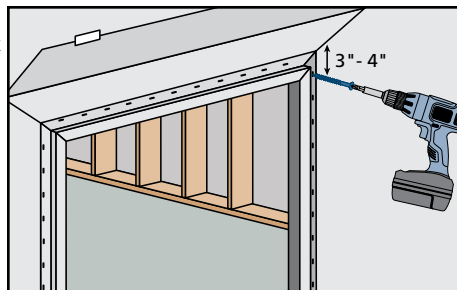

**Shim the Jambs**

**NOTE: Each location should be shimmed with two opposing shims (if tapered). Secure all shims with sealant.**

4. From the interior, shim the hinged side jamb at every hinge (swinging doors). Shim the latch jamb 6" from the corners and at the strike plate.
5. Shim all other jambs 6" from the corners and at center. Shim in additional locations as needed to ensure door is square.
6. Shim the head jamb 6" from the corners of each panel and at the strike plate if present. Position shims so that strike plate/head bracket screws will penetrate shims.
7. Inspect the patio door for square, level and plumb. Test for proper operation (remove and reinstall if necessary).

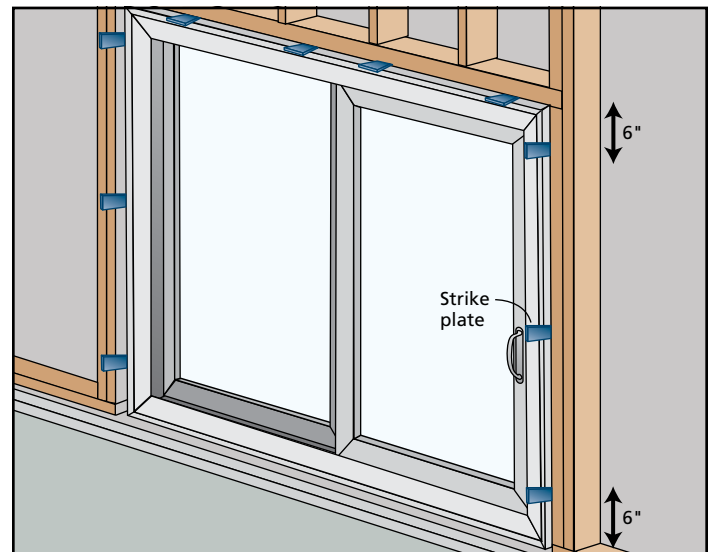

**5** **INSTALL PATIO DOOR - CONTINUED**

- For center hinge patio doors only, check for proper reveal (clearance) between the frame and panels at the side jambs and head as shown.

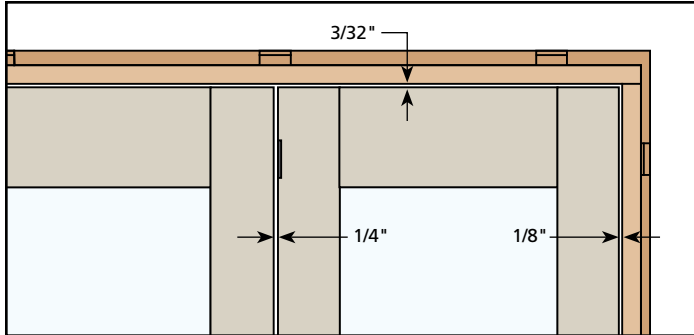

**Secure Patio Door**

**NOTE: Fastener heads must be flush. Do not dent nailing fin. Always use pre-punched holes or pre-drill with a 3/16" bit.**

- Fasten patio door through nailing fin holes, or through exterior trim 3"-7" from the corners and 8" apart all the way around the jamb and head nail fin.
- For doors with a strike plate against a jamb, fasten with provided screws through the holes in the strike plate, replacing the existing strike plate screws if necessary. Does not apply to post or astragal latched doors.

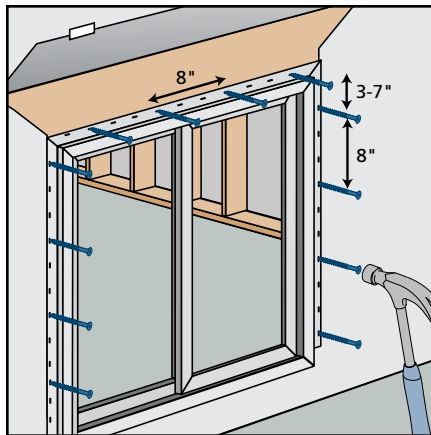

**STEPS 3 and 4 are for swinging doors only**

- Unlock the deadbolt with a small flathead screwdriver and open doors.
- Remove any shipping blocks.
- On the interior, structurally secure side and head jambs by driving one screw through each of the remaining shims.

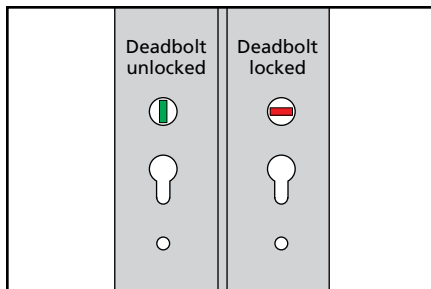

**Apply Drip Cap (wood doors with wood exterior trim only)**

- Cut a piece of drip cap the length of the header trim + 1/4" to allow for 1/8" overlap on each end of the trim.
- Apply 1/4" bead of sealant to header trim as shown.
- Nail drip cap in place as shown.
- Apply sealant underneath the drip cap where it meets both ends of the trim.

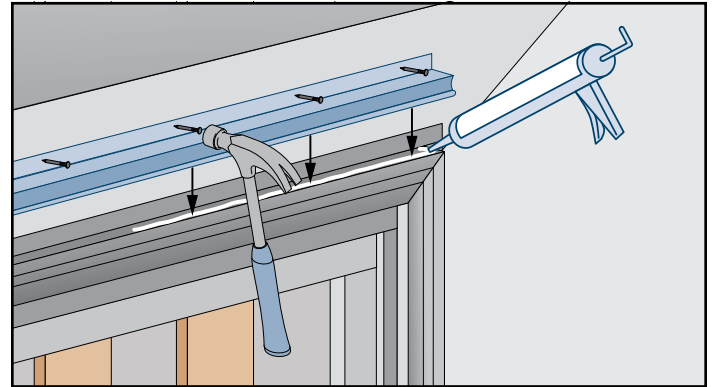

**6**

**COMPLETE INSTALLATION**

Please refer to our product guide: JPG012 on [jeld-wen.com](http://jeld-wen.com) for lock and roller adjustments.

**Adjust Lock**

1. Loosen the lock hook screws in the side jamb so it can be moved up or down.
2. Insert the alignment guide into one of the openings in the faceplate.
3. Carefully close the panel and raise or lower the lock hook until it aligns with the slots in the faceplate. Tighten the screws.
4. To lock the door, rotate the thumb turn 90°.

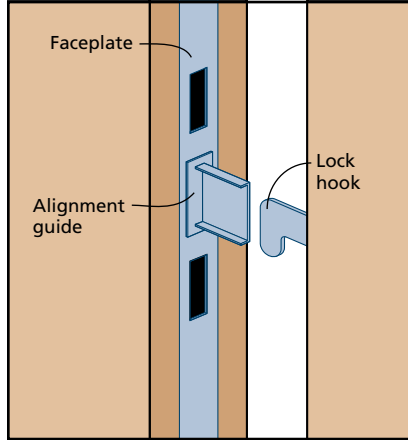

**NOTE: The thumb turn will not lock when the door is open.**

**Adjust Sliding Door Panel Rollers**

**NOTE: Adjust the panel high enough to avoid drag. Keep door stile parallel to the locking jamb by almost closing the door and looking for an even reveal/gap.**

**NOTE: Lift up the panel or use a small pry bar to lift the panel to take the weight off the rollers before adjusting the rollers.**

Roller adjustment plugs may be located on the interior bottom face or end of each operating panel, remove each plug. Using a flat head screwdriver for face adjusted rollers or phillips for end adjusted rollers, turn the screw counterclockwise to raise the panel or clockwise to lower it. Reinstall plugs.

**Complete Installation**

- On the exterior of step-down landings, install support trim underneath the sill where it extends past the landing. Position trim snugly against the bottom of the sill toe.
- Adjust patio door for best operation.

**Continuous Air Seal**

1. Create a continuous air seal on the interior between the rough opening and the door frame with backer rod and sealant or low expansion foam. Allow the foam to fully cure and cut flush with a sharp knife. Make sure the foam cuts cleanly and doesn't tear.
2. Run a continuous bead of polyurethane sealant on the interior side of the sill pan to door frame interface and up each side (edge) of the sill pan to the foam joint. Tool the sealant into a fillet joint. This will tie the fillet beads into the existing air seal and provide redundancy to the existing air seal application.

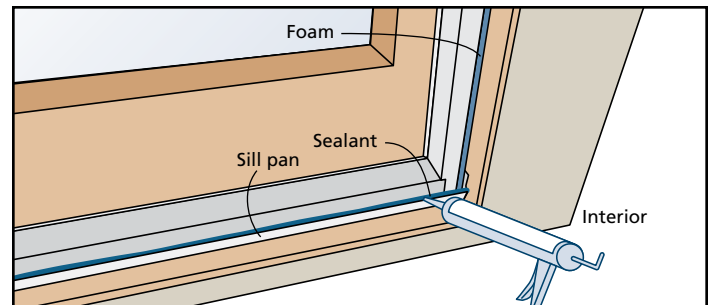



**6**

**COMPLETE INSTALLATION - CONTINUED**

**After Installation**

- Do not nail interior trim to head stop.
- Install exterior wall surface (cladding) per manufacturer's guidelines.
- Seal any gaps or openings at end of horizontal mull joints with sealant.
- Leave an expansion/contraction gap of approximately 3/8" between door frame and final exterior wall surface (siding, stucco, etc.). For a finished look and additional protection, seal this gap on the sides with backer rod and sealant. If sealant is applied above the drip cap ensure the sealant bead is discontinuous to allow for drainage.
- Protect recently installed units from damage from plaster, paint, etc. by covering the unit with plastic.
- Remove protective film (if applicable) on glass within one year and immediately from cladding.
- Finish all exposed wood surfaces immediately following installation.

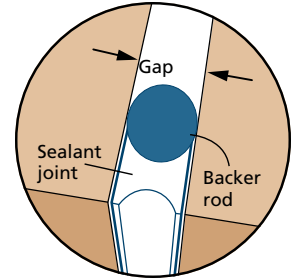
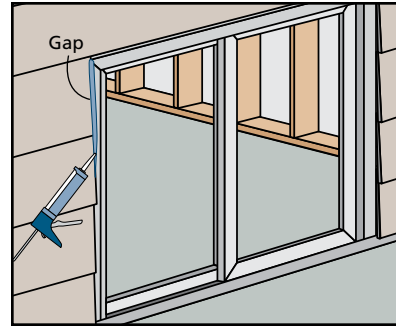
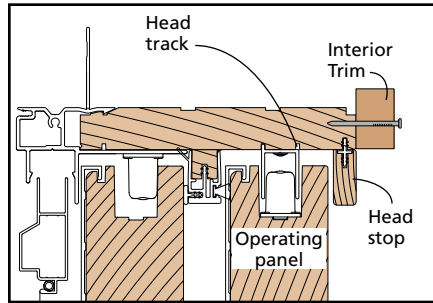

**Please visit [jeld-wen.com](http://jeld-wen.com) for warranty and care and maintenance information.**

**Thank you for choosing**

